

HVS CONNECTOR

EV battery Module High Voltage SOLUTIONS

Product Catalog

2025.Oct Rev A

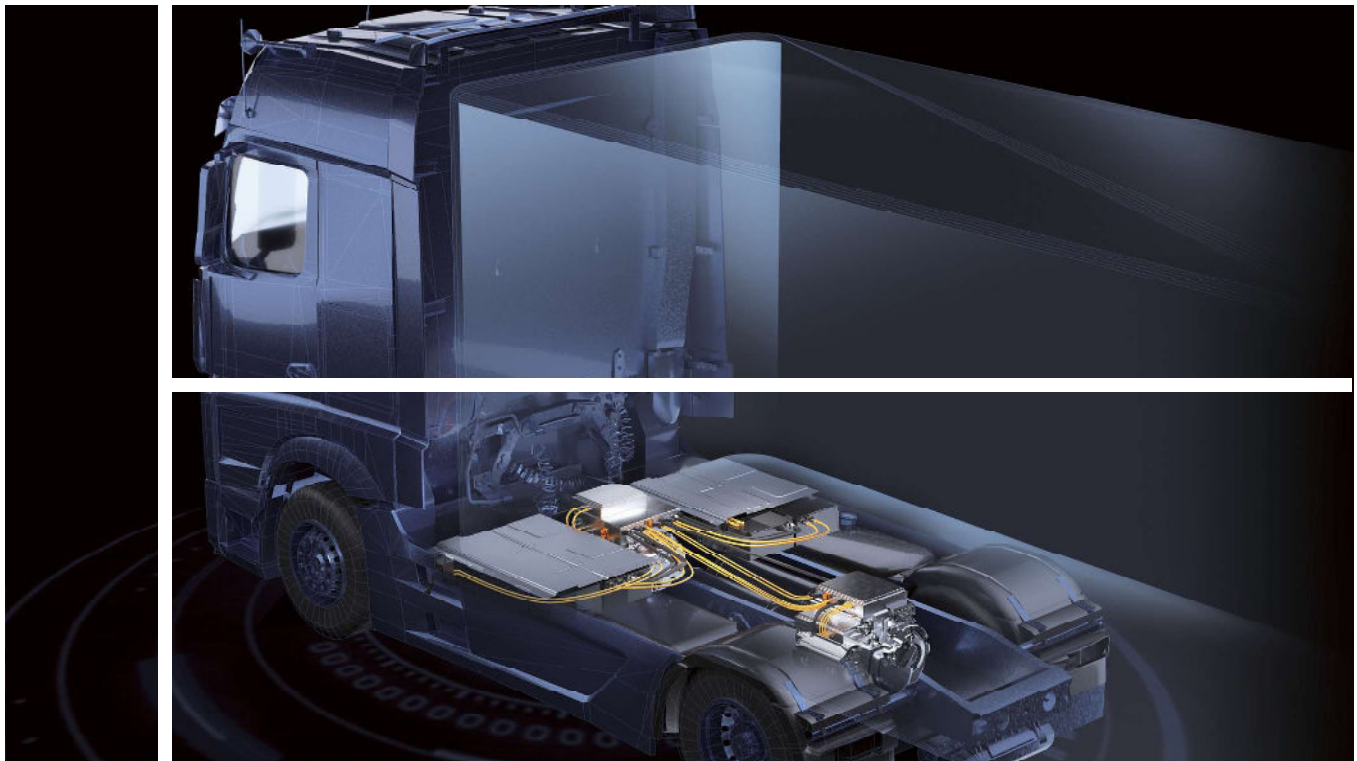

HVS Series

HVS Series Touch-safe bolt termination EV battery Module High Voltage Connection (with busbar)

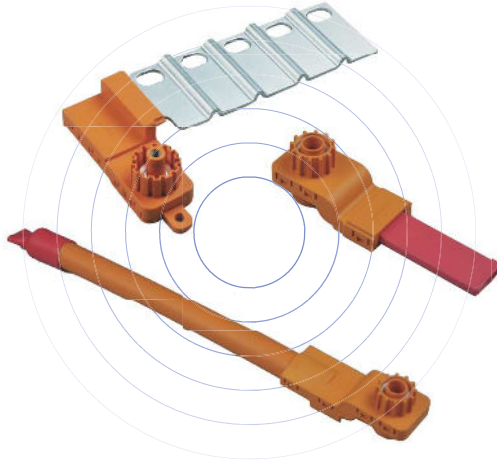

Amphenol GEC's new HVS high-voltage connection system is a versatile, compact, robust, and touch-safe solution for interconnecting cell modules inside a traction battery and high-voltage connection points outside the battery. HVS connection system combines the advantages of solid steel-to-steel bolt termination with the extremely low contact resistance of copper contact elements. The system is touch-safe in unmated and mated conditions. It flexibly interconnects with a large number of available conductors and cross-sections.

The impedance is very good, which is suitable for electrical connection between various battery modules. We can ensure that we leverage our advantages to provide solutions that meet customer's needs.

Key Features

Electric

- ⊗ Rated voltage: 1000V
- ⊗ Rated current: 400A max (with 95mm² cable out)
- ⊗ Insulation resistance: 500MΩ
- ⊗ Dielectric withstanding voltage: 5000V DC

Environmental

- ⊗ Operating temperature: -40~+140℃
- ⊗ Inflammability: UL94 V-0
- ⊗ IP degree: IPXXB ISO 20653
- ⊗ Neutral salt spray: 960H for Fasteners

Mechanical

- ⊗ Keys: 2
- ⊗ Mating and screw cycles: 25max
- ⊗ Vibration: SG 3/LV215
- ⊗ Wire Range: 95mm² max
- ⊗ Connection method: Assembly(Receptacle), Crimping(Plug)



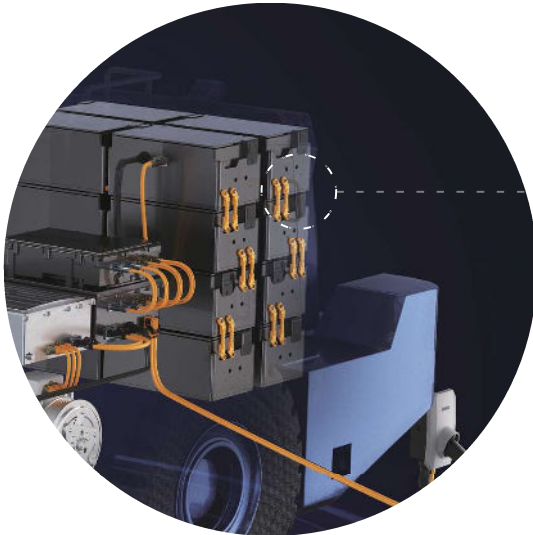

Battery Module

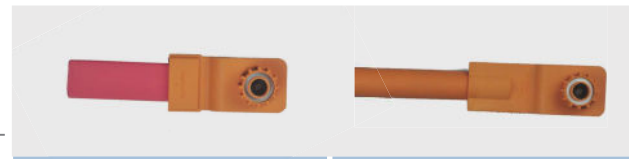

Plug with busbar

Plug with Cable



Receptacle with BM

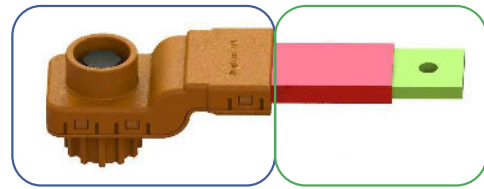

Standard

Customized

Ordering Information

HVS - 0 W A - 400 - BDU XXX

| Product Type | Connector Type | Connection Method | Positioning Code | Current | Accepted Type | Customization |
|---------------|----------------|-------------------|------------------|----------|---------------------------|---------------------|
| HVS Connector | 0 Receptacle | W Welding | A 30 deg | 400 400A | BM Battery Cell connector | Defined by customer |
| | | A Assembly | B 36 deg | | | |

HVS - 1 W A - 400 - 1C - 095 - 090

| Product Type | Connector Type | Connection Method | Positioning Code | Current | Accepted Type | Cable Size | Customization |
|---------------|-----------------|-------------------|------------------|----------|---------------|------------|-----------------------|
| HVS Connector | 1 Straight Plug | W Welding | A 30 deg | 400 400A | 1C Cable | 095 95mm2 | Straight Plug: Height |
| | 2 Angled Plug | | B 36 deg | | 1B Copper Bar | | Angled Plug: Degree |

CONTACT US

Website | www.tpi.com | www.amphenol-gec.com |

Winnipeg, Manitoba, Canada

Tel: +1 204 697 2222

Email: sales@tpi.com

Add: 2110 Notre Dame Ave,
Winnipeg, MB, R3H 0K1, Canada

Pécs, Hungary

Tel: +36-30-528-7432

Email: csaba.szokol@amphenol-asip.com

Add: H-7673 Cserkút, Batvölgyi út 3.

Changzhou, China

Tel: +86 519-8981 9713

Email: sales@amphenol-gec.com

Add: No.11 Fengxiang Road,
New District, Changzhou, Jiangsu, China